

instructions

Kenwood Chef KM300, 400, 410 / Major KM600, 800, 810

Congratulations on buying a Kenwood. With such a wide range of attachments available, it's more than just a mixer. It's a state-of-the-art kitchen machine. We hope you'll enjoy it.

Robust. Reliable. Versatile. Kenwood.

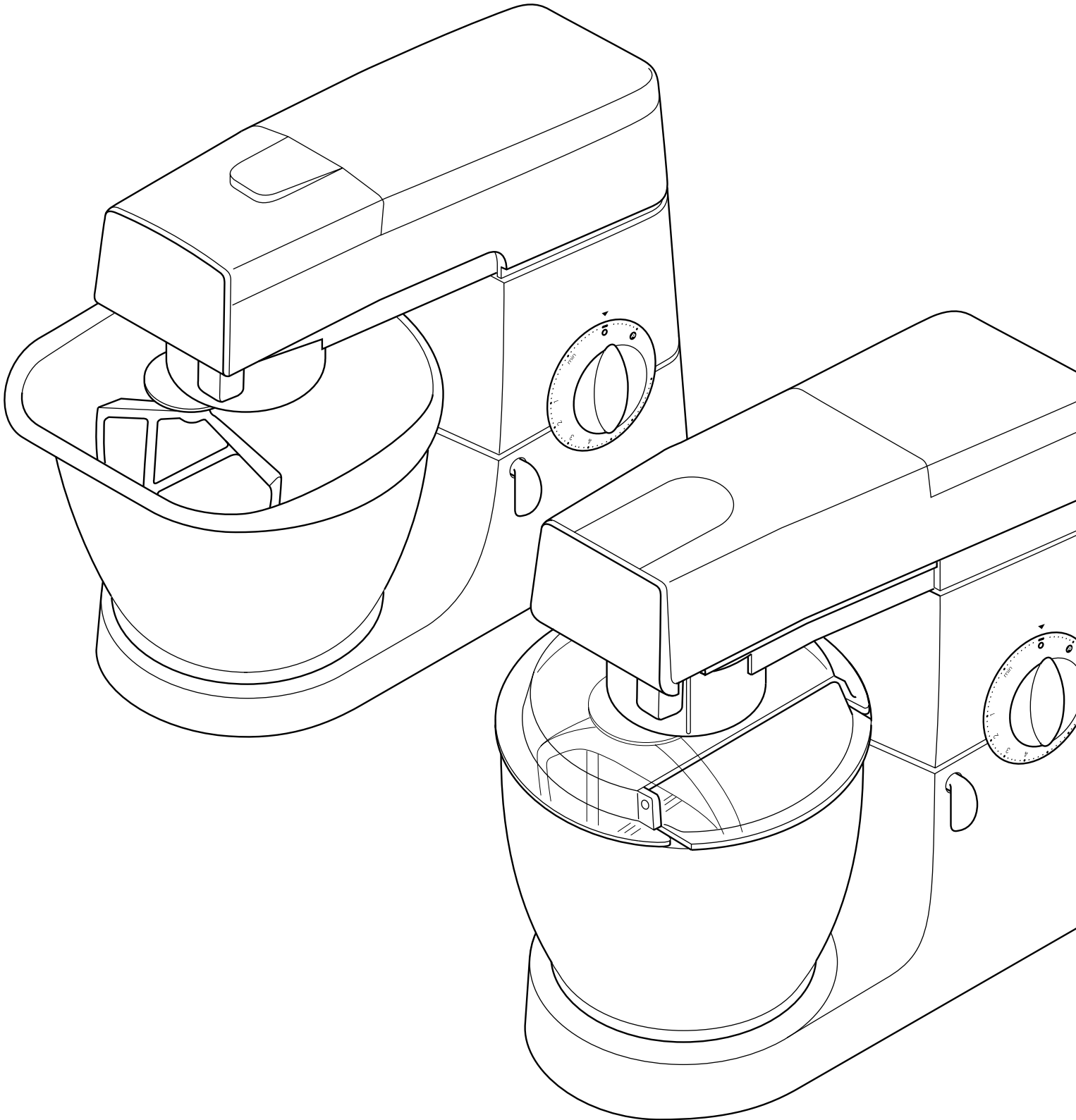

KENWOOD

know your Kenwood kitchen machine

safety

- Switch off and unplug before fitting or removing tools/attachments, after use and before cleaning.
- This machine is not intended for use by young children or infirm persons without supervision.
- Keep your fingers away from moving parts and fitted attachments.
- Never leave the machine on unattended.
- Never use a damaged machine. Get it checked or repaired: see 'service', page 6.
- Never use an unauthorised attachment or more than one attachment at once.
- Never exceed the maximum capacities on page 2.
- Don't let children play with this machine.
- When using an attachment, read the safety instructions that come with it.
- Only use this machine for domestic food preparation.

before plugging in

- important - UK only
- Make sure your electricity supply is the same as the one shown on the underside of your machine.
 - The wires in the cord are coloured as follows:
Blue = Neutral, Brown = Live.
 - This machine complies with European Economic Community Directive 89/336/EEC.

before using for the first time

- 1 Remove all packaging.
- 2 Wash the parts: see 'care and cleaning', page 6.

attachment outlets

know your Kenwood kitchen machine

- the mixer
- ① high-speed outlet
 - ② citrus juicer outlet
 - ③ slow-speed outlet
 - ④ tool socket
 - ⑤ mixer head
 - ⑥ outlet catch
 - ⑦ bowl
 - ⑧ head-lift lever
 - ⑨ on/off and speed switch
 - ⑩ power unit
 - ⑪ K-beater
 - ⑫ whisk
 - ⑬ dough hook
 - ⑭ spatula

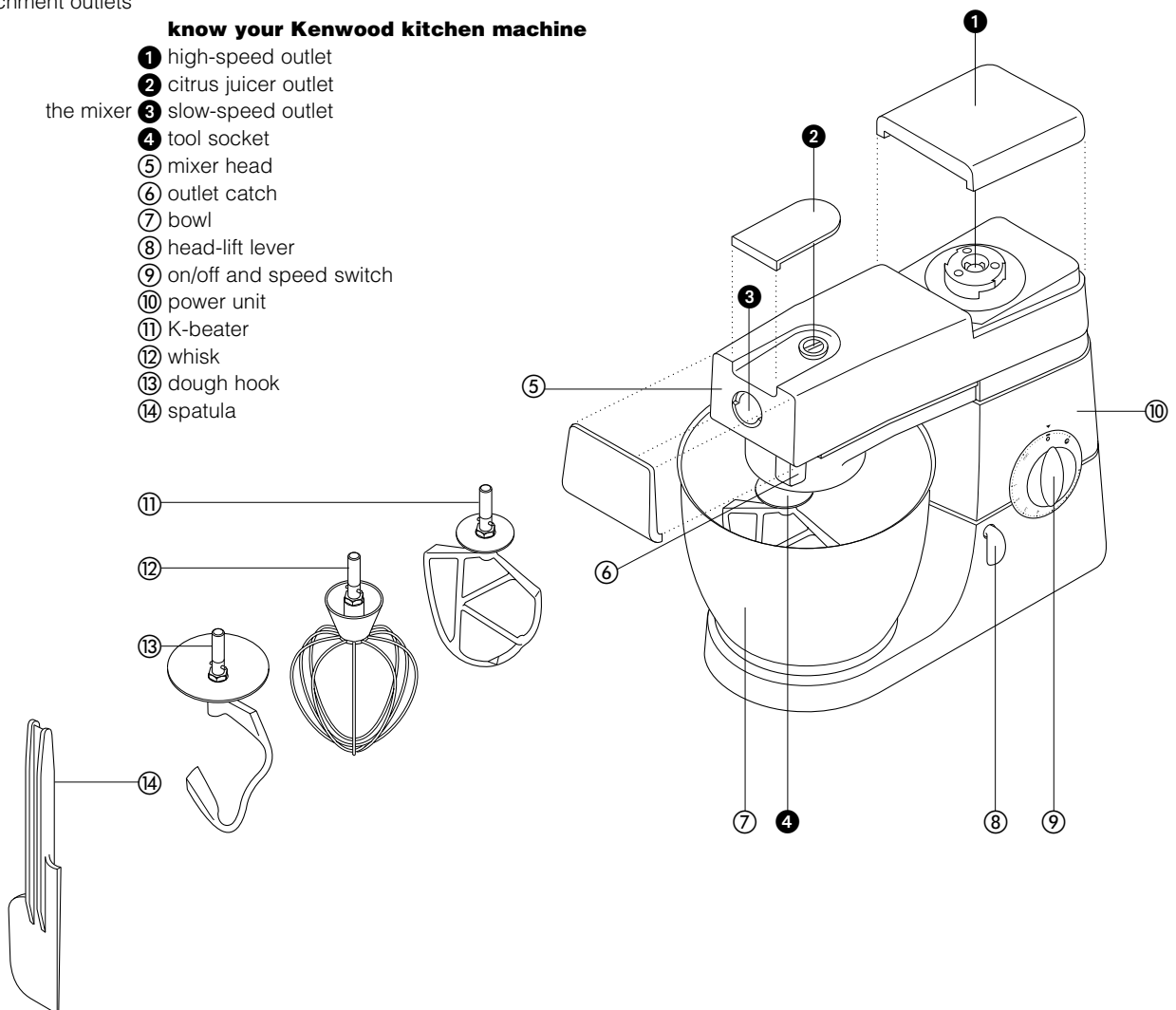

the **attachments** available

To buy an attachment not included in your pack, call your KENWOOD repairer.

attachment attachment code

flat pasta maker ① **A970**

additional pasta attachments
(not shown) used in conjunction
with A970

A971 tagliatelle

A972 taglionini

A973 trenette

A974 spaghetti

pasta maker ② **A936** comes with 6 screens

slow speed slicer/shredder ③ **A948** comes with 4 drums

super mincer ④ **A950** comes with

a large sausage nozzle

b small sausage nozzle

c kebbe maker

grain mill ⑤ **A941**

citrus press ⑥ **A995**

liquidiser ⑦ 1.2 l acrylic **A993A**, 1.2 l glass **A994A**, 1.5 l stainless steel **A996A**

multi-mill ⑧ **A938A** comes with 3 glass jars and 3 lids for storage

high speed slicer/shredder ⑨ **A998** comes with 3 cutting plates

optional plates a extra coarse shredder **part number 639021**

b rasping plate **part number 639150**

c standard chipper **part number 639083**

continuous juice extractor ⑩ **A935**

ice-cream maker ⑪ CHEF **A953**, MAJOR **A954**

potato peeler ⑫ CHEF **A934**, MAJOR **A952**

colander and sieve ⑬ CHEF **A992**, MAJOR **A930**

kenlyte round bowl ⑭ CHEF **265026**, MAJOR **412095**

round splashguard a CHEF & MAJOR **444347**

kenlyte D-shaped bowl ⑮ CHEF **489969**

D-shaped splashguard a CHEF **604349**

stainless steel bowls ⑯ polished: CHEF **638821**, MAJOR **642779**

cover ⑰ CHEF **533722**, MAJOR **606397**

